

You have complete creating room floor plans, and individual house plans using the information from chapter 16. You will now be building a 3D house, in groups, using the 3D house kits. Before you start building your house you need to create a one-floor house plan. This time you will be using AI to help you create your floorplan. You will have to analyze any changes needed and try to get AI to make the appropriate changes. After this you will discuss the floor plan with your group, what will you keep from the created floorplan and what needs to change to create the flow and design you had envisioned.

Directions:

1. Write a paragraph using AI to create a floor plan. You must share your paragraph with me.

- Start your paragraph with: create a floor plan and exterior for a house
- The details that you put into AI need to be very specific. Include details about features (bay window, built in cabinets, Kitchen island, Peninsula, etc.
- Style of house, ranch, Victorian, cape code
- Number of rooms and bathrooms
- Extra rooms size of closets extra closets and storage?
 - Storage room, craft room, billiards room, library, playroom?
- Number of cars to fit in garage
- Open-floor-plan or closed?

Example – *this is what I typed into ChatGBT*

Create a floor plan and exterior for a house. The floor plan needs to be an open floor plan except I want a playroom on a second story and only the playroom, a closet, and half bath on the second story. There needs to be three bedrooms on the main floor. All with walk in closets, the main bedroom should have two walk-in closets and a large bathroom with a toilet closet and a wet room with a large tub and two shower heads. There should only be one sink but plenty of countertop space for two people. The kitchen should include plenty of cabinetry and an island where 4 bar stools can sit. I want a double wall oven. There should be a coat closet in the front and mudroom where the washer and dryer go at the entrance from the garage. The garage should fit two cars with extra space to store items. I want a double door in the front and sliding glass doors to the backyard through the living room. I want the house to be craftsman style using sage green and brown. Create a picture of the floorplan with dimensions and a picture of the exterior with landscaping.

Edit 3

Change the location of the mudroom with the entry. Change the location of the wet room with the toilet rooms

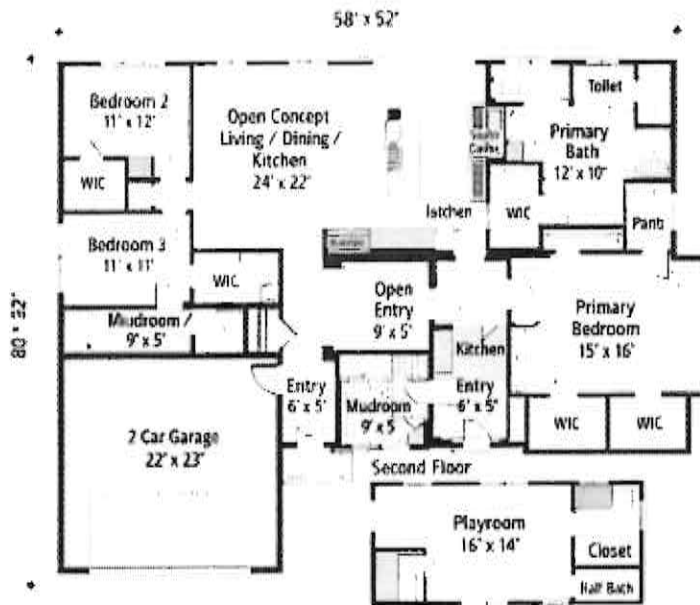

Result Three



2. There are still flaws in the design. You need to look through the floorplan very carefully. Pretend you are walking through it. Are there rooms you can only get to from another room? Is the master bathroom connected only through the living room? Take note of these errors. Now you need to draw out the room on graph paper or the peel and stick kits. Make the corrections or move a room or door around to make the floorplan a livable space. Make sure you use 1/4" scale.

3. Make sure you create a document that includes your paragraph, two edit statements. And all three picture results. **Due: Thursday April 16th**

4. After you make the needed changes and draw your floor plan. **Drawn Floor Plan due date: W April 22nd**

Standards

11.7.2 Prepare sketches, elevations, perspectives, and renderings using appropriate media

11.4 Demonstrate design, construction document reading, and space planning skills required for the housing, interior design and furnishings industries.

11.4.4 Arrange furniture placement with reference to principles of design, traffic flow, activity, and existing architectural features.

11.7.6 Create floor plans using architectural drafting skills and computer aided design software.